

QUY50A

液压履带式起重机

HYDRAULIC CRAWLER CRANE



抚顺挖掘机制造有限责任公司
FUSHUN EXCAVATOR CORPORATION LTD.

Courtesy of Crane.Market

QUY50A

液压履带式起重机

HYDRAULIC CRAWLER CRANE

- QUY50A液压履带式起重机是我公司采用国外先进技术制造的全回转、多用途的履带式起重机，可广泛用于建筑、交通、港口、能源及农田水利等部门完成吊重、安装及搬运物料等各种作业。
- 该机对地面的比压小，可在河滩、田野上行走和作业；转弯半径小，适用狭窄环境；可一机多用，更换起重、打桩、抓铲及拉铲等作业设备；可吊重行走和自落下放重物，作业效率高。该机重量轻、体积小，操作性能好，其各种性能及可靠性已达到国际同类产品水平。
- QUY50A Hydraulic crawler crane is a kind of full hydraulic, multiple purpose, crawler mounted crane is designed and manufactured with advanced technology from abroad, It can be widely used in various departments such as construction, transportation, port, energy and agriculture, water conservancy etc. to accomplish all kinds of operation such as lifting, mounting and material handling.
- The ground pressure of this machine is small, so it is able to travel and work in Goodland and field, Small turning radius makes it suitable for restricted working environment, it is a machine with functions, crane, piledriver, draline and clamshell attachments etc. and also be fitted on the main machine; it can travel with heavy load and the load can be lowered through free fall motion which results in high productivity; it is light in dead weight, small in built-up and good in performance. its various performance. Its various and reliabilities have caught up with the world's early 90's advanced level of the same kind product.



抚顺挖掘机制造有限责任公司
FUSHUN EXCAVATOR CORPORATION LTD.

Courtesy of Crane.Market



功能简介

Function brief introduction

■ 该机的设计采用了日本日立公司液压履带起重机的先进技术，液压系统为总功率变量负载反馈。控制系统采用先导比例控制，微动性能好，动作平稳，精确度高。提升机构采用带式制动器，带式离合器，具有重力下放功能。生产效率高，能耗低，属于节能型产品。该机的外观采用流线设计，油漆全部采用进口烤漆，既美观，又便于机械的维护与保养。

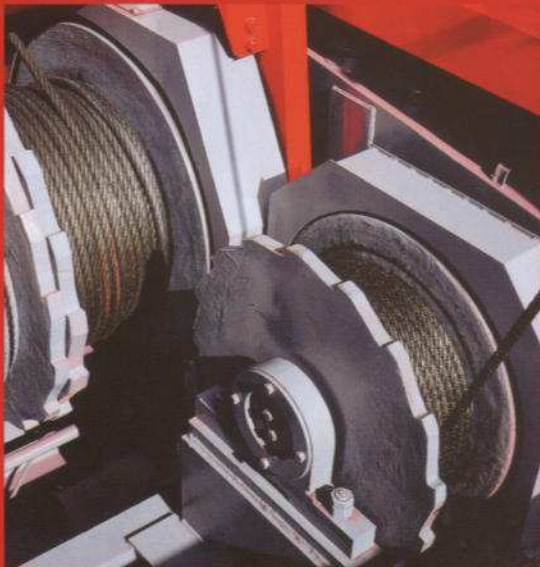
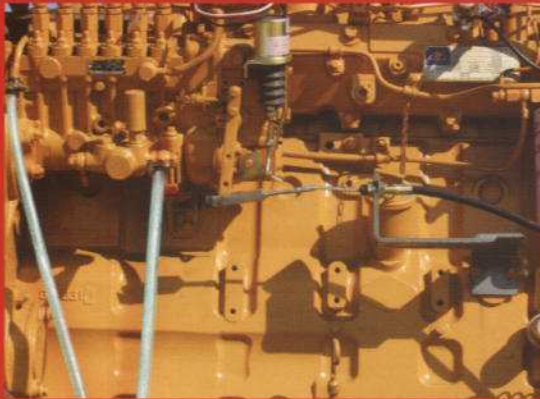

■ The design of QUY50A adopts advanced technology of hydraulic crawler crane from HITACHI, Japan. The hydraulic system is total power variable load feedback. Pilot proportional control is applied in control system. It can realize characteristics of high performance of fine speed, smooth moving and high control precision. Band brake and band clutch which applied in hoisting mechanism realize the function of free fall. It is a kind of energy-saving product with high productivity and low energy cost. The appearance of streamline body and imported paint make the machine look attractive and easy to access for maintenance.





QUY50A

中国·扶控

危险
作业时禁止靠近

安全装置

Safety devices

- 该机配备有载荷预警装置—力矩限制器。力矩限制器能为操作者准确提供全部作业参数。可实现超载保护，以确保机器运行安全。同时具有提升高度限位，变幅防后倾限位。并在提升、变幅和回转机构中设有止动装置，能够保证机器的安全性。
- Load pre-warning device -Moment Limiter provides whole parameters for the operator. The safety operation can be ensured by over-load protection. Hoisting height limit and boom retroversion limit also can be realized. Lock devices are equipped in hoist, boom hoist and swing devices to ensure the machine safety.



操作舒适

Comfortable operation

- 提供美观和舒适的工作空间。
- 扩大了前方视野。
- 采用了先导操纵，操纵灵活、方便、省力、平稳。
- 配置了空调装置，使司机能够在舒适温度下工作。
- Provide handsome and comfortable working space.
- Large front view.
- Pilot control applied on this machine realizes flexible, convenient, easy and smooth operation.
- The cab is equipped with air conditioner. The operator can work at suitable temperature.



技术参数

Specifications

QUY50A 主要技术参数 Technical Data

项 目 Item	数值 Data	单位 Unit	项 目 Item	数值 Data	单位 Unit
最大起重量 Max. Machine weight	50	t	回转速度 Swing Speed	2.7	Min ⁻¹
主臂长度 Length of Main Boom	13~52	m	行走速度 Travel Speed	1.1	km/h
主臂加副臂最大长度 Length of Main Boom+Fly Jib	43+15.25	m	爬坡能力 Gradeability	40	%
起重臂变幅角度 Boom Hoist Angle	30~80	°	柴油机额定输出功率 Engine Output	128/2000	D6114 KW/Min ⁻¹
提升钢绳速度 Hook Hoisting Speed	70 35	m/min	主提升倍率 Main Hoisting line parts	9	
下降钢绳速度 Hook Lowering Speed	70 35	m/min	接地比压 Ground Pressure	0.069	Mpa
起重臂上升钢绳速度 Boom Hoisting Speed	※ 45	m/min	配重质量 Counter Weight	16	t
起重臂下降钢绳速度 Boom Lowering Speed	※ 45	m/min	整机质量 Max. Machine weight	50	t
起重力矩 Lifting Torque	180	t-m	主机尺寸 Main body dimensions L × W × H	6745 × 3300 × 3080	mm

注：※速度随机载不同而变化

QUY50A 起重机主要外形尺寸图

General Dimensions

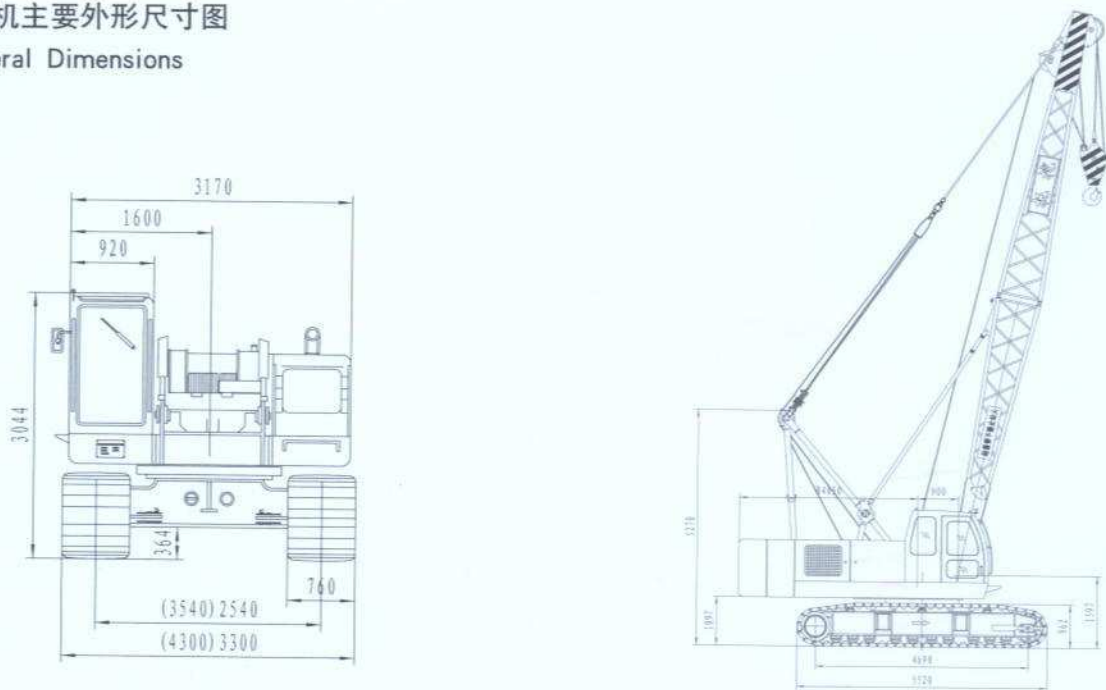

QUY50A 起重机主臂起重性能表 Load Chart of QUY50A with Standart Boom Configuration

单位 Unit:t

主臂长度(M) Boom length 工作半径(M) Working radius	13	16	19	22	25	28	31	34	37	40	43	46	49	52
3.7	50.00													
4.0	43.00	44.95												
4.5	35.00	36.40	37.30											
5.0	29.00	30.60	31.00	31.10										
5.5	25.00	26.40	26.70	26.77	26.55									
6.0	22.00	23.00	23.40	23.45	23.23	23.15								
7.0	18.00	18.50	18.70	18.71	18.48	18.42	18.30							
8.0	15.00	15.30	15.50	15.49	15.25	15.21	15.11	15.00	14.90					
9.0	12.60	13.10	13.20	13.16	12.92	12.89	12.79	12.65	12.57	12.50	12.45			
10.0	11.00	11.30	11.50	11.40	11.15	11.13	11.03	10.89	10.81	10.73	10.68	10.55	10.45	
12.0	8.60	8.90	9.00	8.91	8.66	8.64	8.55	8.40	8.32	8.22	8.16	8.06	7.93	8.00
14.0		7.30	7.34	7.23	6.98	6.97	6.88	6.73	6.64	6.53	6.47	6.35	6.24	6.20
16.0			6.14	6.03	5.77	5.77	5.68	5.53	5.44	5.32	5.25	5.13	5.02	4.96
18.0				5.12	4.86	4.86	4.77	4.62	4.53	4.41	4.34	4.21	4.10	4.02
20.0				4.41	4.15	4.16	4.06	3.91	3.83	3.70	3.62	3.49	3.38	3.29
22.0					3.58	3.59	3.50	3.34	3.26	3.12	3.05	2.91	2.80	2.70
24.0						3.12	3.03	2.88	2.79	2.65	2.57	2.43	2.33	2.22
26.0							2.64	2.49	2.40	2.26	2.18	2.04	1.79	1.82
28.0								2.16	2.07	1.93	1.85	1.70	1.60	1.48
30.0								1.88	1.79	1.65	1.56	1.41	1.32	1.18
32.0									1.54	1.40	1.31	1.16	1.07	0.93
34.0										1.18	1.10	0.95	0.85	0.71

备注(Notes)

抚顺挖掘机制造有限责任公司

地址：辽宁省抚顺市顺城区双阳路2号

邮编：113126

<http://www.cnfuwa.com>

销售公司电话：+86-413-7647 989/7642 419

传真：+86-413-7642 419

售后服务中心电话：+86-413-7641 727

电子信箱：sale@cnfuwa.com

进出口公司电话：+86-413-7649 117/7642 766

传真：+86-413-7642 766

电子信箱：export@cnfuwa.com

免费服务电话：800-890-0009

FUSHUN EXCAVATOR CORPORATION LTD.

Add:No.2 Shuangyang Road, Shuncheng District, Fushun

Liaoning, China

p.c. 113126

<http://www.cnfuwa.com>

China Market Sale Dept. Tel: +86-413-7647 989 / 7642 419

Fax: +86-413-7642 419

After sale Service Dept. Tel: +86-413-7641 727

E-mail: sale@cnfuwa.com

Import & Export Dept. Tel: +86-413-7649 117 / 7642 766

Fax: +86-413-7642 766

E-mail: export@cnfuwa.com

Free Service Tel: 800-890-0009

技术参数如有更改恕不另行通知

Specifications may vary without prior notice